

Self-Guided Plant Identification Walk: Burnaby - Deer Lake Park

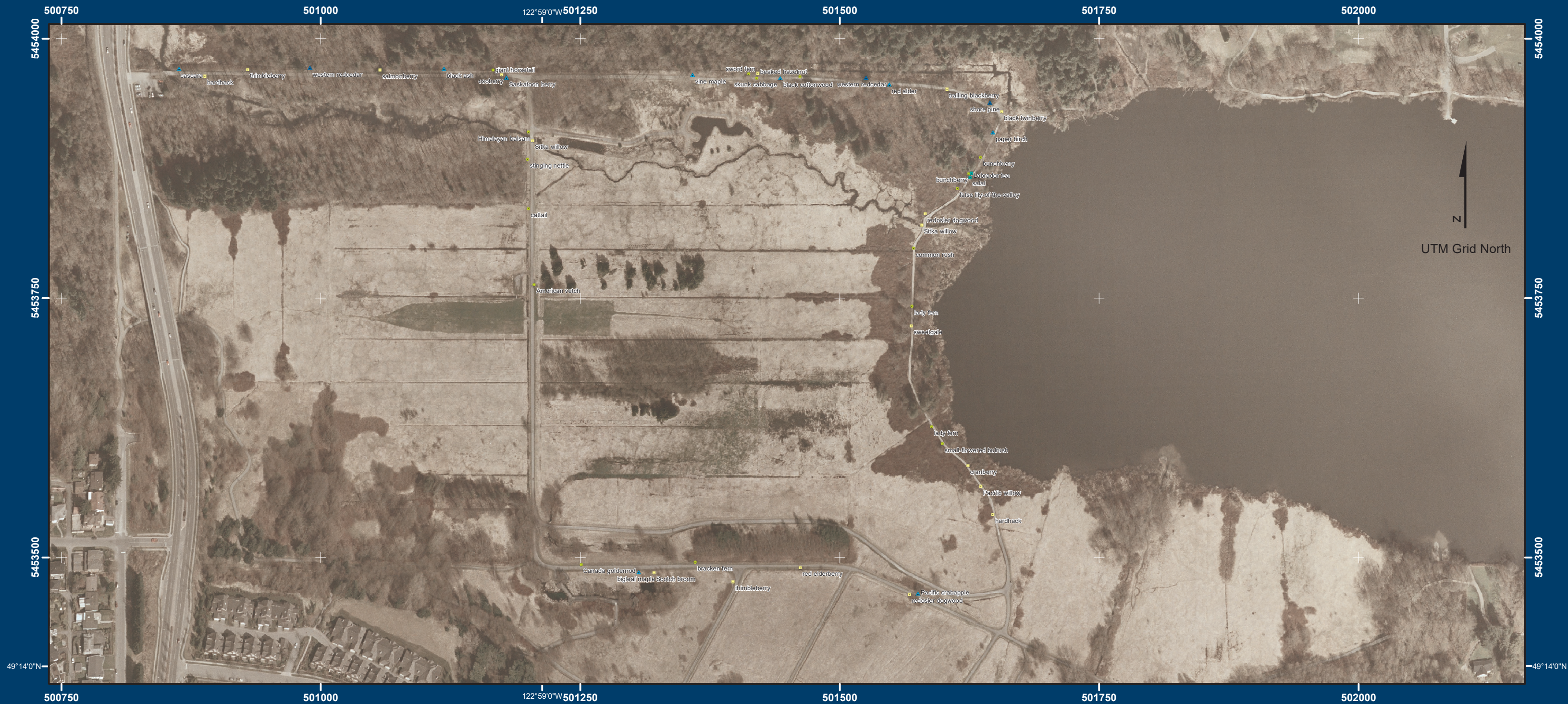

1:3,500

Map By: Stacey Auld
Map Date: June 10, 2021
Point features collected October 2020

Coordinate System: NAD 1983 UTM Zone 10N
Projection: Transverse Mercator
Datum: North American 1983
False Easting: 500,000.0000
False Northing: 0.0000
Central Meridian: -123.0000
Scale Factor: 0.9996
Latitude Of Origin: 0.0000
Units: Meter

Legend

- Herb, Herbaceous
- Shrub, Broadleaf evergreen
- ▣ Shrub, Deciduous
- ▲ Tree, Conifer
- ▲ Tree, Deciduous

This Self-Guided Plant Identification Map is georeferenced to be used with free navigation programs such as Avenza PDF Maps. Download the PDF and open it on a mobile device to follow along and find each plant.

It is recommended to bring along a plant identification field guide such as Plants of Coastal British Columbia (Pojar and MacKinnon) to learn more about the plants as you locate them.

Thank you to the BCIT Open Education Grant Program for providing funding to create these maps! This and more can be accessed at <https://open.bcit.ca/grantprojects>